

HAZARDOUS AREA BREATHER DRAIN PLUGS

Hazardous Area Brass Breather Drain Plugs

The Exd (Type BDM**D) and the Exe (Type BDM**E) effectively drain moisture from an enclosure and allow air from the enclosure to vent into the surrounding atmosphere thereby minimising moisture build up.

- The Exe version is supplied with a castellated nut or optional serrated washer and standard locknut for high vibration applications.
- Drains water from equipment susceptible to moisture collection.
- Enables equipment to breathe whilst maintaining protection levels.

Equipment Protection Levels:

IECEX: (BD**E) Exe IIC Gb / Ex tb IIIC Db (BD**D) Ex d IIC Gb / Ex tb IIIC Db
 ATEX/UKEX:(BD**E) ⓈII 2 G D Ex eb IIC Gb / Ex tb IIIC Db (BD**D) ⓈII 2 G D Ex db IIC Gb / Ex tb IIIC Db
Certification: IECEx CML 16.00021X IEC 60079-0, IEC 60079-1, IEC 60079-7,
 IEC 60079-31
 ATEX CML 16ATEX1029X EN 60079-0, EN 60079-1, EN 60079-7,
 EN 60079-31



IP Protection: IP66 (Exe) / IP6X (Exd)

Temperature Range: -20°C to 95°C

Material: Brass / Nickel Plated Brass



• BDM**D-UN



• BDM**E-UN

Code	Protection		Entry Thread			
	Level		Type	Min Length (L1)	A/F	A/C
BDM20D-UN	Exd		M20 x 1.5	15.0	24.0	27.0
BDM25D-UN	Exd		M25 x 1.5	15.0	32.0	36.0
BDN050D-UN	Exd		½" NPT	15.0	24.0	27.0
BDN075D-UN	Exd		¾" NPT	15.0	32.0	36.0

- For Nickel Plated remove -UN when ordering

Code	Protection		Entry Thread			
	Level		Type	Min Length (L1)	A/F	A/C
BDM20E-UN	Exe		M20 x 1.5	12.0	24.0	27.0
BDM25E-UN	Exe		M25 x 1.5	12.0	32.0	36.0
BDN050E-UN	Exe		½" NPT	15.0	24.0	27.0
BDN075E-UN	Exe		¾" NPT	15.0	32.0	36.0

- For Nickel Plated remove -UN when ordering

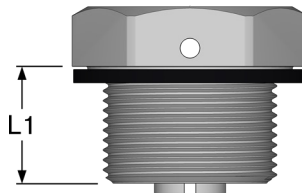

• BDM**D-UN

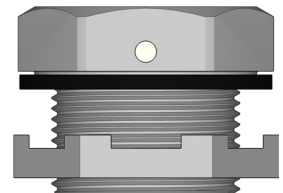

• BDM**E-UN