

### Fibre Sealing Washers

• ISO Metric range. Resistant to sea water corrosion, petroleum derivative, organic oil solvents, sunlight and abrasion

**Standards:** IEC 667 BS 6091  
ASTM D710

**Temperature Range:** 0°C to 100°C

**Material:** Vulcanised fibre

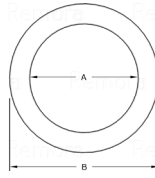

Code	Gland Entry	ID (A)	OD (B)
FW16	M16	16.5	25.0
FW20S	M20	20.3	28.5
FW20L	M20	20.3	35.0
FW25	M25	25.3	36.0
FW32	M32	32.3	42.5
FW40	M40	40.3	51.5
FW50	M50	50.3	64.5
FW63	M63	63.5	79.5
FW75	M75	75.5	90.0

### PTFE Sealing Washers

PTFE Sealing Washers have very high temperature resistance and are resistant to nearly all known acids, alkalis, fuel and oils.

**Standards:** FDA compliant, UL94 V0

**Temperature Range:** -200°C to 260°C

**Material:** White PTFE (Teflon)

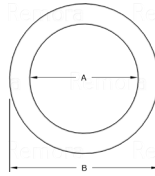

Code	Gland Entry	ID (A)	OD (B)
PTFE16	M16	16.5	25.0
PTFE20	M20	20.5	30.0
PTFE25	M25	25.5	36.0
PTFE32	M32	32.5	42.5
PTFE40	M40	40.5	52.0
PTFE50	M50	50.5	64.5
PTFE63	M63	63.5	80.0
PTFE75	M75	75.5	95.0

### Serrated Washers

• ISO Metric range, Anti-Vibration, Corrosion Resistant.

**Standards:** DIN 6798

**Temperature Range:** 250°C / 400°C Max

**Material:** BZP Steel or 316 (A4) Stainless Steel

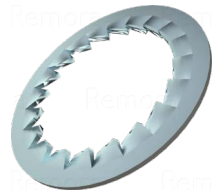
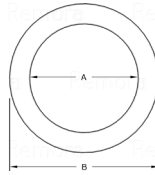

• Bright Zinc Plated



• 316 Stainless Steel

Zinc Plated	Gland Entry	ID (A)	OD (B)	No of Teeth	Stainless	Gland Entry	ID (A)	OD (B)	No of Teeth
M16WSER	M16	17.3	25.5	16.0	SSM16WSER	M16	17.3	25.5	16.0
M20WSER	M20	21.3	32.5	16.0	SSM20WSER	M20	21.3	32.5	16.0
M25WSER	M25	25.3	37.5	16.0	SSM25WSER	M25	25.3	37.5	16.0
M32WSER	M32	33.0	48.0	18.0	SSM32WSER	M32	33.0	48.0	18.0
M40WSER	M40	41.0	60.0	20.0	SSM40WSER	M40	41.0	60.0	20.0
M50WSER	M50	51.0	71.0	24.0	SSM50WSER	M50	51.0	71.0	24.0
M63WSER	M63	64.0	87.0	30.0	SSM63WSER	M63	64.0	87.0	30.0
M75WSER	M75	76.0	102.0	34.0	SSM75WSER	M75	76.0	102.0	34.0