

Junction Boxes & Enclosures | IP68 ENCLOSURES

UTILITY JUNCTION BOX

Utility Box

IP68 GRP 4-Way Junction Box



The Utility Box is a general purpose junction box suitable for all surface industrial applications. It is manufactured from impact, corrosion and UV resistant glass reinforced polyester compound and provides 1,2,3 or 4 way versatility. Screw on lid provides ease of installation and when locked with locking key prevents unauthorised tampering.

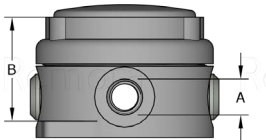
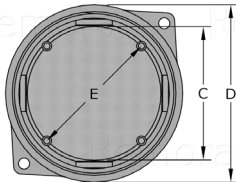

Utility Box

- No exposed metal parts
- Dust and water proof to IP68 when used with approved CCG glands
- One box offers 1, 2, 3 or 4 way versatility for reduced stock holding
- No drilling or tapping of cable entries required
- Mounting studs provided for DIN rail terminals
- Internal earth continuity ring to earth gland entries
- Screw on lid provides ease of installation locked with a special key to prevent unauthorised tampering and ease of installation

Protection: IP66
IP68

Temperature Range: -60°C to 110°C

Material: Impact, Corrosion and UV Resistant Glass Reinforced Polyester

Colour: Grey



Code	Reference Size	(A)	(B)	(C)	(D)	(E)
102101	1 - M20	M20 x 1.5	62	80	120	70
102102	2 - M25	M25 x 1.5	66	108	150	97

Utility Box - 2 Way Assemblies



Through box assembly. IP66/67/68 weatherproof suitable for indoor / outdoor use, above and below ground. Designed to join two steel wire armoured cables together.

Code	Entry Thread	Glands	Armoured Cable OD
102101/A1	M20 x 1.5	2x M20s	11.5 - 16.0
102101/A2	M20 x 1.5	2x M20	14.5 - 21.0

Utility Box - 3 Way Assemblies



Through box assembly. IP66/67/68 weatherproof suitable for indoor / outdoor use, above and below ground. Designed to join two steel wire armoured cables together with flex loop off option.

Code	Entry Thread	Glands	Armoured Cable OD	Unarmoured Cable OD
102101/A3	M20 x 1.5	2x M20s + 1x M20ss	11.5 - 16.0	3.0 - 8.0
102101/A4	M20 x 1.5	2x M20s + 1x M20s	11.5 - 16.0	8.0 - 12
102101/A5	M20 x 1.5	2x M20 + 1x M20	14.5 - 21.0	11.0 - 14.5

Utility Box Locking Keys

Anti-tamper locking keys.



Code	Reference Size	Box Code
UTS1	1 - M20	102101
UTS2	2 - M25	102102