

POSIFIT ATEX JUNCTION BOX

Posifit Box

EExe 4 Way Junction Box



The POSIFIT EExe 4-Way / Y Boxes are supplied for use in increased safety areas. They are manufactured from impact, corrosion and UV resistant glass reinforced polyester compound, and provides 1,2,3 or 4 way versatility. Screw on lid provides ease of installation and when locked with locking key prevents unauthorised tampering. POSIFIT range of enclosures are ATEX certified Ex'e' and are suitable for use in Category 2 Zone 1 & 21 and Category 3 Zone 2 & 22 areas.

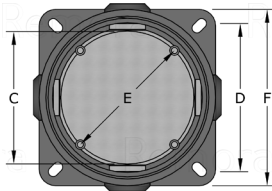

Posifit Box

- No exposed metal parts
- Dust and water proof to IP68 when used with approved Remora glands
- One box offers 1, 2, 3 or 4 way versatility for reduced stock holding
- No drilling or tapping of cable entries required
- Mounting studs provided for DIN rail terminals
- Internal earth continuity ring to earth gland entries
- High temperature resistance, corrosion resistance & anti-static properties
- Only approved CCG cables glands and Ex e terminals must be used

Protection: IP66
IP68

Ambient Temperature Range: -60°C to 55°C (Finished)

Survive Temperature Range: -60°C to 110°C (Unfinished)

Material: Impact, Corrosion and UV Resistant Glass Reinforced Polyester

Colour: Black

Standards: CENELEC / ATEX Zones 1, 2, 21 & 22 EExe II



Code	Reference Size	(A)	(B)	(C)	(D)	(E)	(F)
1003-0	0 - M20s	M20 x 1.5	52.0	71.0	79.0	65.0	100.0
100301	1 - M20	M20 x 1.5	58.0	92.0	92.0	80.0	118.0
100302	2 - M25	M25 x 1.5	67.0	108.0	107.0	98.0	140.0
100303	3 - M32	M32 x 1.5	105.0	166.0	167.0	150.0	203.0
100304*	4 - M40	M20,M25, M32 or M40 x 1.5	139.0	225.0	240.0	246.0	298.0

* 100304 available with M20, M25, M32 or M40 Entries



Posifit Box - Y Box

Through box assembly. IP66/67/68 weatherproof suitable for indoor / outdoor use, above and below ground. Ideal for industrial applications, outdoor lighting etc. Designed to join two steel wire armoured cables.

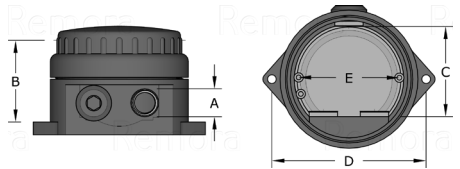

Code	Reference Size	(A)	(B)	(C)	(D)	(E)
1009-0	0 - M20s	M20 x 1.5	52.0	60.0	108.0	62.0
100901	1 - M20	M20 x 1.5	58.0	75.0	132.0	77.0
100902	2 - M25	M25 x 1.5	67.0	94.0	148.0	95.0
100903	3 - M32	M32 x 1.5	105.0	150.0	237.0	152.0