

### PG-Metric Nylon Adaptors

Remora PG-Metric Nylon Adaptors enable the use metric cable glands in machines, devices and housings that have a pre-existing PG threaded entry.

**Protection:** IP56

IP66 (if fitted with sealing washer)

**Temperature Range:** -40°C to 100°C (static)

**Material:** PA6 (Nylon)

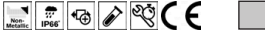

Code	Male Thread	Female Thread	Male Thread Length (L1)	A/F	Body Height
APG7M16N	PG7 x 1.27	M16 x 1.5	9.0	20.0	18.0
APG9M16N	PG9 x 1.41	M16 x 1.5	9.0	20.0	18.0
APG9M20N	PG9 x 1.41	M20 x 1.5	9.0	24.0	18.0
APG11M16N	PG11 x 1.41	M16 x 1.5	9.0	22.0	18.0
APG11M20N	PG11 x 1.41	M20 x 1.5	9.0	24.0	18.0
APG13M20N	PG13.5 x 1.41	M20 x 1.5	10.0	24.0	18.0
APG13M25N	PG13.5 x 1.41	M25 x 1.5	10.0	29.0	18.0
APG16M25N	PG16 x 1.41	M25 x 1.5	10.0	29.0	18.0
APG21M32N	PG21 x 1.59	M32 x 1.5	12.0	36.0	18.0
APG29M40N	PG29 x 1.59	M40 x 1.5	12.0	46.0	18.0
APG36M50N	PG36 x 1.59	M50 x 1.5	14.0	55.0	18.0
APG42M63N	PG42 x 1.59	M63 x 1.5	14.0	68.0	18.0

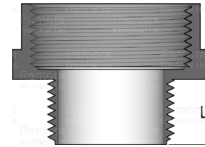

### PG-Metric Nylon Reducers

Remora PG-Metric Nylon Reducers enable the use metric cable glands in machines, devices and housings that have a pre-existing PG threaded entry.

**Protection:** IP56

IP66 (if fitted with sealing washer)

**Temperature Range:** -40°C to 100°C (static)

**Material:** PA6 (Nylon)



Code	Male Thread	Female Thread	Male Thread Length (L1)	A/F	Body Height
RPG16M20N	PG16 x 1.41	M20 x 1.5	10.0	27.0	18.0
RPG21M25N	PG21 x 1.59	M25 x 1.5	12.0	33.0	18.0
RPG29M32N	PG29 x 1.59	M32 x 1.5	12.0	42.0	18.0
RPG36M40N	PG36 x 1.59	M40 x 1.5	14.0	53.0	18.0
RPG42M40N	PG42 x 1.59	M40 x 1.5	14.0	60.0	18.0
RPG42M50N	PG42 x 1.59	M50 x 1.5	14.0	60.0	18.0
RPG48M50N	PG48 x 1.59	M50 x 1.5	15.0	65.0	18.0



Call the Remora sales team at **01226 352 000**

Challenge us - We find a solution